



- Optional: Pluggable, easily retrofittable Ex e or Ex i auxiliary contacts for control and signalling purposes
- Motor switching capacity AC-3 as per IEC/EN 60947-3
- Variants for use in the USA/Canada available on request
- Wide temperature range for use
- High mechanical impact and shock resistance
- Perfect protection against the ingress of liquids and dust
- 3D data available to download from the website

WebCode **8571A**



R. STAHL Series 8571/11 SolConeX sockets for Zone 1/21 in a 3-, 4- and 5-pole version have full AC-3 switching capacity up to 32 A. The high degree of protection IP66 guarantees the highest level of protection against the penetration of dust and/or water in any application position. Self-cleaning lamellar contacts provide optimum contact and the plugs can be inserted and removed in the zero position quickly and easily. The load disconnect switch, with mechanical locking device and a handle that can be locked in the 0 or I position, is an additional safety feature.

	IECEX / ATEX					
Zone	0	1	2	20	21	22
Installation in		•	•		•	•

Selection Table								
Product Description Product variant	Wall-mounting socket 32 A Standard							
Figure	Detailed number of poles	Coding (clock hour position)	Rated operational voltage AC	Colour code	Frequency range	Product Type	Art. No.	Weight kg
	3 P + N + PE	3	220/380 V AC	Red	50 Hz	8571/11-503	217678	2.200
		4	57/100 to 75/130 V AC	Yellow	50 / 60 Hz	8571/11-504	217679	2.200
		5	347/600 to 400/690 V AC	Black	50 / 60 Hz	8571/11-505	150876 ■	2.200
		6	200/346 to 240/415 V AC	Red	50 / 60 Hz	8571/11-506	150854 ▲	2.200
		7	277/480 to 288/500 V AC	Black	50 / 60 Hz	8571/11-507	150863 ■	2.200
	3 P + PE	5	600 to 690 V AC	Black	50 / 60 Hz	8571/11-405	150902 ■	2.200
		6	380 to 415 V AC	Red	50 / 60 Hz	8571/11-406	150890 ▲	2.200
		7	480 to 500 V AC	Black	50 / 60 Hz	8571/11-407	150894 ■	2.200
		9	200 to 250 V AC	Blue	50 / 60 Hz	8571/11-409	150898 ■	2.200
		10	> 50 V AC	Green	100 – 300 Hz	8571/11-410	150906	2.200
		11	440 to 460 V AC	Red	60 Hz	8571/11-411	150910 ■	2.200

Selection Table

Product Description		Wall-mounting socket 32 A						
Product variant		Variants with auxiliary contact 1 (1 NO)						
Auxiliary contacts								
Figure	Detailed number of poles	Coding (clock hour position)	Rated operational voltage AC	Colour code	Frequency range	Product Type	Art. No.	Weight kg
	3 P + PE	6	380 to 415 V AC	Red	50 / 60 Hz	8571/11-406-S001	220135 ■	2.200
		7	480 to 500 V AC	Black	50 / 60 Hz	8571/11-407-S001	166610 ■	2.200
Product Description		Wall-mounting socket 32 A						
Product variant		Variants with metal earth plate for double metal insert and stopping plug						
Figure	Detailed number of poles	Coding (clock hour position)	Rated operational voltage AC	Colour code	Frequency range	Product Type	Art. No.	Weight kg
	3 P + N + PE	6	200/346 to 240/415 V AC	Red	50 / 60 Hz	8571/11-506-S012	214069 ■	2.200
	3 P + PE	5	600 to 690 V AC	Black	50 / 60 Hz	8571/11-405-S012	220134	2.200
		6	380 to 415 V AC	Red	50 / 60 Hz	8571/11-406-S012	214068	2.200
		7	480 to 500 V AC	Black	50 / 60 Hz	8571/11-407-S012	220133	2.200
		9	200 to 250 V AC	Blue	50 / 60 Hz	8571/11-409-S012	220132	2.200



Variants with a temperature range from -50 to +55 °C available on request; silicone as sealing material

Technical Data

Variant	8571/11-...	8571/11-...-S001	8571/11-...-S012
Explosion Protection			
IECEx gas explosion protection	Ex db eb IIC T6 ... T5 Gb	Ex db eb IIC T6 ... T5 Gb	Ex db eb IIC T6 ... T5 Gb
IECEx dust explosion protection	Ex tb IIIC T60 °C / T75 °C Db	Ex tb IIIC T60 °C / T75 °C Db	Ex tb IIIC T60 °C / T75 °C Db
ATEX gas explosion protection	⊕ II 2 G Ex db eb IIC T6 ... T5 Gb	⊕ II 2 G Ex db eb IIC T6 ... T5 Gb	⊕ II 2 G Ex db eb IIC T6 ... T5 Gb
ATEX dust explosion protection	⊕ II 2 D Ex tb IIIC T60 °C / T75 °C Db	⊕ II 2 D Ex tb IIIC T60 °C / T75 °C Db	⊕ II 2 D Ex tb IIIC T60 °C / T75 °C Db
Certificates	IECEx (PTB), Korea (KGS), Taiwan (ITRI)	IECEx (PTB), Korea (KGS), Taiwan (ITRI)	IECEx (PTB), Korea (KGS), Taiwan (ITRI)
Electrical Data			
Rated operational current	32 A	32 A	32 A
Switching capacity main contacts	7.5 kW: 220 to 240 V 15 kW: 380 to 415 V 30 kW: 600 to 690 V	7.5 kW: 220 to 240 V 15 kW: 380 to 415 V 30 kW: 600 to 690 V	7.5 kW: 220 to 240 V 15 kW: 380 to 415 V 30 kW: 600 to 690 V
Notes	The current must be reduced to 25 A for frequencies ≥ 100 Hz		
Device Specific Data			
Back-up fuse with thermal protection	63 A gG	63 A gG	63 A gG
Back-up fuse without thermal protection	35 A gG	35 A gG	35 A gG
Ambient Conditions			
Ambient temperature	-30 °C ... +40 °C (T6) -30 °C ... +55 °C (T5)	-30 °C ... +40 °C (T6) -30 °C ... +55 °C (T5)	-30 °C ... +40 °C (T6) -30 °C ... +55 °C (T5)
Notes	Variants with a temperature range from -50 to +55 °C available on request; silicone as sealing material For further information, see the operating instructions.		
Mechanical Data			
IP degree of protection (IEC 60529)	IP66	IP66	IP66
IP degree of protection (IEC 60079)	IP66	IP66	IP66
Enclosure material	Polyamide, Glass fibre reinforced	Polyamide, Glass fibre reinforced	Polyamide, Glass fibre reinforced
Silicone-free	Yes	Yes	Yes
Impact strength (IEC 60079)	7 J	7 J	7 J
Impact strength (IEC 62262)	IK10	IK10	IK10

Technical Data			
Variant	8571/11-...	8571/11-...-S001	8571/11-...-S012
Mechanical Data			
Lockable in	in 0- and I-position	in 0- and I-position	in 0- and I-position
Components			
Cable entry note	Entry 1: Lower left Entry 2: Lower right	Entry 1: Lower left Entry 2: Lower right	Entry 1: Lower left Entry 2: Lower right
Entry 1 model	8161/7-M32-2109	8161/7-M32-2109	Can be ordered as accessories
Entry 1 type	Polyamide cable gland	Polyamide cable gland	
Entry 1	M32 x 1.5	M32 x 1.5	M32 x 1.5
Entry 1 terminal area	9 – 21 mm	9 – 21 mm	
Entry 2 model	8290/3-M32	8161/7-M25-1707 with plug	8290/3-M32
Entry 2 type	Polyamide stopping plug	Polyamide cable gland	Polyamide stopping plug
Entry 2	M32 x 1.5	M25 x 1.5	M32 x 1.5
Entry 2 terminal area		7 – 17 mm	
Notes	Metal insert: Contains a brass plate with threaded holes Cable gland position: Bottom (standard); optionally also possible on the top or lateral		

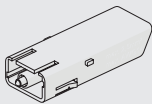
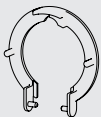
You can find more technical data online at r-stahl.com

Accessories			
Figure	Description	Art. No.	Weight kg
Auxiliary contact optional, can be connected by the user, easy to retrofit			
	1 NC max. 500 V AC, max. 110 V DC max. 6 A 1 x 0.5 to 2 x 2.5 mm ² solid/finely stranded	150680 ■	0.125
	1 NC, gold-plated contact max. 500 V AC, max. 110 V DC max. 6 A 1 x 0.5 to 2 x 2.5 mm ² solid/finely stranded	150684 ■	0.125
	1 NO max. 500 V AC, max. 110 V DC max. 6 A 1 x 0.5 to 2 x 2.5 mm ² solid/finely stranded	150682 ■	0.125
	1 NO, gold-plated contact max. 500 V AC, max. 110 V DC max. 6 A 1 x 0.5 to 2 x 2.5 mm ² solid/finely stranded	150686 ■	0.125
Dust cover for 32 A wall-mounting sockets, series 8571			
	Retrofit dust protection for 5-pole sockets	253117	0.009
Dust cover for 8571 series 32 A wall-mounting sockets			
	Retrofit dust protection for 4-pole sockets	255005	0.009

Spare Parts

Figure	Description	Art. No.	Weight kg
Repair set for 8571 series 32 A sockets			
	8571 4-pole hinged cover repair set, black	275505	0.165
	8571 4-pole hinged cover repair set, blue	275502	0.165
	8571 4-pole hinged cover repair set, green	275501	0.165
	8571 4-pole hinged cover repair set, red	275504	0.165
	8571 5-pole hinged cover repair set, black	275490	0.170
	8571 5-pole hinged cover repair set, red	275489	0.170
	8571 5-pole hinged cover repair set, yellow	275488	0.170

Dimensional Drawings (All Dimensions in mm [inches]) – Subject to Alterations

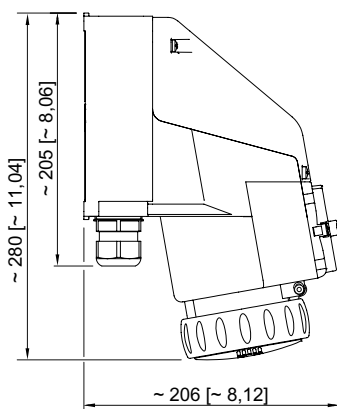
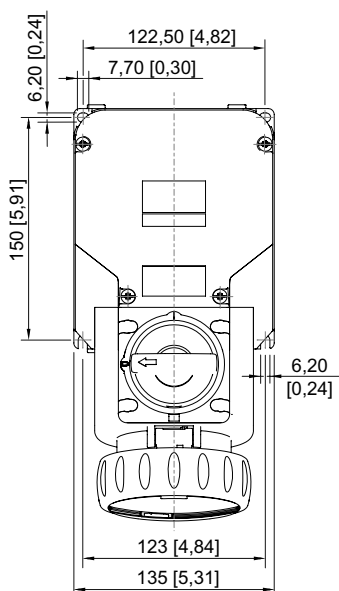
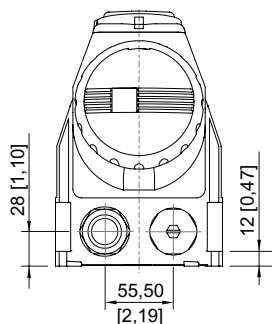

Wall-mounting socket

Arrangement of earth contact sleeves

Time position
Example: 6h position

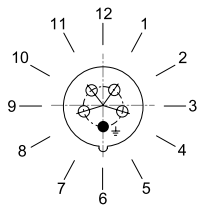

Arrangement of socket contacts and terminal markings

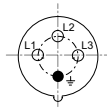

3 P + PE

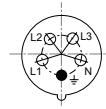

3 P + N + PE

Arrangement of the socket contacts and terminal markings in the 6h position
(view from the front side of the shrouded socket outlet to the socket contacts)