

Control Devices

Control device for panel mounting

Ex e

8003/121-001S UL Art. No. 217837



- Flexible configuration due to pushbutton, mushroom push-button, mushroom stay-put button, mushroom stay-put button with key lock, key-operated button, key-operated switch
- Easy assembly thanks to single-hole mounting
- Codable "latching", "spring return", "key not removable" functions
- Spring clamp terminals with connection chamber

MY R. STAHL 8003A



The switches and control buttons for R. STAHL series 8003 panel mounting devices have various switching functions in latching and spring return versions, which can be subsequently recoded, up to 6 A. They are completely certified, explosion-protected equipment with Ex e connection chambers. With the patented mounting mechanism, panel mounting with normal drilled holes of 30.5 mm is quick and easy.

The right actuators are available for a comprehensive range of applications.

Technical Data

Explosion Protection

Scope of validity	European Union (ATEX) CEC IECEX NEC
Application range (zones)	1 2 21 22
IECEX gas certificate	IECEX PTB 06.0065X
IECEX gas explosion protection	Ex db eb IIC T6 Gb
IECEX dust certificate	IECEX PTB 06.0065X
IECEX dust explosion protection	Ex tb IIIC T80 °C Db
ATEX gas certificate	PTB 02 ATEX 1057 X
ATEX gas explosion protection	⊕ II 2 G Ex db eb IIC T6 Gb
ATEX dust certificate	PTB 02 ATEX 1057 X
ATEX dust explosion protection	⊕ II 2 D Ex tb IIIC T80 °C Db
Certificates	ATEX (PTB), Canada (UL), IECEX (PTB), Korea (KGS), USA (UL)
Declaration of Conformity	ATEX (EUK), ATEX (Simple apparatus), China (CCC), Declaration of Conformity (ATEX)
Notes	Product label may vary. Series devices have certification according to ATEX, IECEX, NEC® and CE Code.

Electrical Data

Rated operational voltage AC	500 V
Rated operational current	6 A
Switching capacity AC-12	500 V / 6 A / max. 3000 VA
Switching capacity AC-15	400 V / 6 A / max. 1250 VA
Switching capacity DC-13	110 V / 1 A / max. 110 W

Control Devices

Control device for panel mounting

Ex e

8003/121-001S UL Art. No. 217837



Electrical Data

Switching capacity DC-13<SoftReturn/>2 contact elements in series	60 V/6 A
---	----------

Ambient Conditions

Ambient temperature	-55 °C ... +60 °C
Ambient temperature	-67 °F ... +140 °F
Ambient temperature NEC®	-55 °C ... +60 °C
Ambient temperature NEC®	-67 °F ... +140 °F

Mechanical Data

Degree of protection (IP) (IEC 60529)	Reverse side IP65, front side IP66
Enclosure material	Polyamide
Contact material	Silver-nickel
Silicone-free	No
Number of NCs	2
Connection cross-section	0.75 ... 1.5 mm ²
Connection cross-section AWG	18 AWG ... 12 AWG
Depth of cut-out	130 mm
Mounting depth, inches	5.12 in
Service life, min.	10 ⁵ operating cycles
Weight	140 g
Weight	0.31 lb

Mounting / Installation

Tightening torque	3 Nm
Tightening torque lbf in	26.55 lbf in

Components

Actuator	Pushbutton
Entry 1	8161/7-M16-0902
Entry 1 type	Polyamide cable gland, black

Technical Drawings – Subject to Alterations

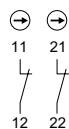

Schematic 8003/12.
NC positive opening

Dimensional Drawings (All Dimensions in mm [inches]) – Subject to Alterations

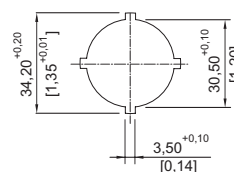
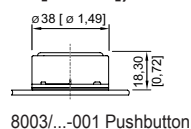
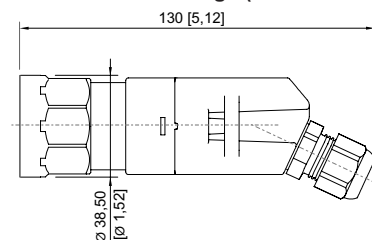

Cut-out details

Control Devices

Control device for panel mounting

Ex e

8003/121-001S UL Art. No. 217837

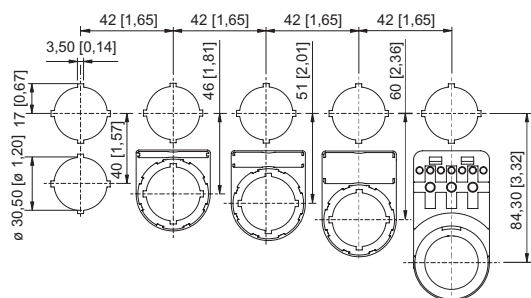

Cut-out with/without additional designation plate

Accessories

Actuator



Pushbutton

Art. No.

155525

Locking devices



8602A0753 H24 for not actuated pushbutton/selector switch
BG001, BG005

Art. No.

155372



8602A0754 for actuated pushbutton/selector switch
BG001, BG005

155402



8602A0755 for not actuated pushbutton/selector switch
BG001, BG005

155431

Protective collar



8602A0751 metal
for pushbutton/selector switch/mushroom stay-put button with key lock/mushroom stay-put
button/mushroom pushbutton dia. 39
BG001, BG003, BG005, BG008, BG009, BG010, BG012

Art. No.

155326

Spare Parts

Label mount



Label mount, size 1, without symbol label
Text: 1 line
for actuators to fit Ø 30.5 mm holes

Art. No.

155632



Label mount, size 2, without symbol label
Text: 1 or 2 lines
for actuators to fit Ø 30.5 mm holes

155687

Control Devices

Control device for panel mounting

Ex e

8003/121-001S UL Art. No. 217837



	Label mount, size 3, without symbol label Text: 1, 2 or 3 lines for actuators to fit Ø 30.5 mm holes	155844
--	--	--------

Symbol label for pushbutton and selector switch	Art. No.
---	----------

	Colour: blue Please specify text or symbol	155910
--	---	--------

	Colour: green Please specify text or symbol	155900
--	--	--------

	Colour: white Text: START	155889
--	------------------------------	--------

	Colour: blue Text: RESET	155894
--	-----------------------------	--------

	Colour: green Text: START	155721
--	------------------------------	--------

	Colour: black Text: Ab	155886
--	---------------------------	--------

	Colour: black Text: Auf	155883
--	----------------------------	--------

	Colour: black Symbol: Arrow	155749
--	--------------------------------	--------

	Colour: black Symbol: Arrow	155761
--	--------------------------------	--------

	Colour: black Text: Links	155827
--	------------------------------	--------







Control Devices

Control device for panel mounting

Ex e

8003/121-001S UL Art. No. 217837



	Colour: black Text: Rechts	155837
	Colour: black Text: Open	155868
	Colour: black Text: CLOSE	155878
	Colour: black Text: Zu	155874
	Colour: red Text: OFF	155654
	Colour: green Text: ON	155671

Insert discs for label holder

Art. No.

	One-line Plain Material: PVC Colour: White Self-adhesive	238271
--	--	--------

Symbol label for pushbutton and selector switch

Art. No.

	Colour: red Text: AUS	155634
--	--------------------------	--------

Insert discs for label holder

Art. No.

	Two-line Plain Material: PVC Colour: White Self-adhesive	238272
--	--	--------

Symbol label for pushbutton and selector switch

Art. No.

	Colour: black Text: AUS	155806
--	----------------------------	--------

Control Devices

Control device for panel mounting

Ex e

8003/121-001S UL Art. No. 217837





Insert discs for label holder

Art. No.

	Three-line Plain Material: PVC Colour: White Self-adhesive	238273
--	--	--------

Symbol label for pushbutton and selector switch

Art. No.

	Colour: black Text: EIN	155862
	Colour: red Text: STOP	155615
	Colour: black Text: STOP	155795

Closing part

Art. No.

	8602C3-733-B for closing unused holes in cover, dia. 30.5 mm, NBR	244306
	8602C3-733-S for closing unused holes in cover, dia. 30.5 mm, silicone	244307

Symbol label for pushbutton and selector switch

Art. No.

	Colour: black Text: I	155846
	Colour: green Text: I	155689
	Colour: white Text: I	155892
	Colour: black Text: II	155854
	Colour: green Text: II	155706

Control Devices

Control device for panel mounting

Ex e

8003/121-001S UL Art. No. 217837



	Colour: red Text: O	155596
	Colour: black Text: O	155783
	Colour: black Text: I O	155771
	Colour: blue Blank label without text	155911
	Colour: yellow Blank label without text	155914
	Colour: red Blank label without text	155897
	Colour: green Blank label without text	155901
	Colour: white Blank label without text	155908
	Colour: black Blank label without text	155905

We reserve the right to make alterations to the technical data, dimensions, weights, designs and products available without notice. The illustrations cannot be considered binding.