

8118/132-542-0 Art. No. 224646

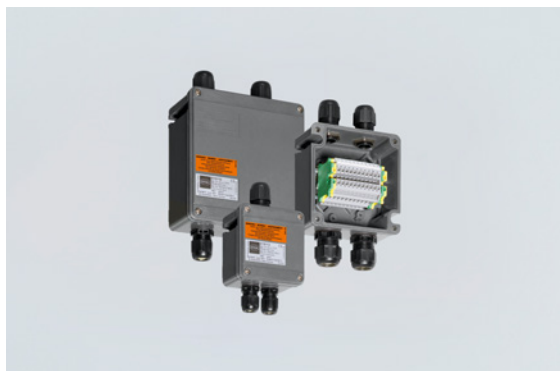

- Compact, impact-resistant enclosure, also available in versions with integrated metal bracket for optimised installation of cable glands
- Customer-specific equipping with terminals, cable glands and miniature fuses
- IP66 degree of protection

### MY R. STAHL 8118B



R. STAHL Series 8118 terminal boxes are equipped, in accordance with customer specifications, with various series terminals and cable glands made from plastic or metal, if required also with miniature fuses. They are available in 3 design sizes and are made from glass fibre reinforced polyester resin.

## Technical Data

### Explosion Protection

Scope of validity	European Union (ATEX) IECEX
Application range (zones)	1 2 21 22
IECEX gas certificate	IECEX PTB 06.0026
IECEX gas explosion protection	Ex eb IIC T6 / T5 Gb
IECEX dust certificate	IECEX PTB 06.0026
IECEX dust explosion protection	Ex tb IIIC T80 °C / T95 °C Db
ATEX gas certificate	PTB 99 ATEX 3103
ATEX gas explosion protection	⊕ II 2 G Ex eb IIC T6 / T5 Gb
ATEX dust certificate	PTB 99 ATEX 3103
ATEX dust explosion protection	⊕ II 2 D Ex tb IIIC T80 °C / T95 °C Db
Certificates	ATEX (PTB), Brazil (ULB), China (NEPSI), IECEX (PTB), India (PESO), Korea (KTL)
Declaration of Conformity	China (CCC)
Explosion protection note	For product label, see scope of validity.

### Electrical Data

Rated operational voltage AC	690 V
Max. number of conductors for conductor cross-section 1.5 mm <sup>2</sup>	At 3 A: 36 <sup>*)</sup> At 6 A: 36 <sup>*)</sup> At 10 A: 26 <sup>*)</sup> At 16 A: 6 <sup>*)</sup>
Max. number of conductors for conductor cross-section 2.5 mm <sup>2</sup>	At 3 A: Any At 6 A: 36 <sup>*)</sup> At 10 A: 36 <sup>*)</sup> At 16 A: 18 <sup>*)</sup> At 20 A: 6 <sup>*)</sup>

8118/132-542-0 Art. No. 224646

### Electrical Data

Max. number of conductors for conductor cross-section 4 mm <sup>2</sup>	At 3 A: Any At 6 A: Any At 10 A: 32 <sup>*)</sup> At 16 A: 32 <sup>*)</sup> At 20 A: 22 <sup>*)</sup> At 25 A: 8 <sup>*)</sup>
Max. number of conductors for conductor cross-section 6 mm <sup>2</sup>	At 3 A: Any At 6 A: Any At 10 A: Any At 16 A: 24 <sup>*)</sup> At 20 A: 24 <sup>*)</sup> At 25 A: 24 <sup>*)</sup> At 35 A: 6 <sup>*)</sup>
Max. number of conductors for conductor cross-section 10 mm <sup>2</sup>	At 3 A: Any At 6 A: Any At 10 A: Any At 16 A: Any At 20 A: 20 <sup>*)</sup> At 25 A: 20 <sup>*)</sup> At 35 A: 20 <sup>*)</sup> At 50 A: 4 <sup>*)</sup>
Max. number of conductors note	Each inserted conductor and each internal connection conductor counts as a conductor. Jumpers and protective conductors do not count.  <sup>*)</sup> When using these values, simultaneity factors or load factors must be taken into account according to IEC 61439. A mixed assembly with electrical circuits of different cross sections and currents is possible with proportional utilisation of the different tables of values.

### Ambient Conditions

Ambient temperature	-40 °C ... +40 °C (T6) -40 °C ... +55 °C (T5)
Ambient temperature	-40°F ... +104°F (T6) -40°F ... +131°F (T5)

### Mechanical Data

Degree of protection IP (IEC 60529)	IP66
Enclosure material	Polyester resin, Glass fibre reinforced
Enclosure colour	Dark grey
Flammability according to	IEC/EN 60695 UL 94 ASTM D635
Silicone-free	No
Cover	Screw-on cover
Cover fixing type	M4 stainless steel screws, With captive screws
Width	145 mm
Width, inches	5.71 in
Height	145 mm
Height, inches	5.71 in
Depth	71 mm
Depth, inches	2.8 in
Packaging unit	1
Weight	890 g

8118/132-542-0 Art. No. 224646

### Mechanical Data

Weight	1.96 lb
--------	---------

### Mounting / Installation

Tightening torque of cover screw 1	1.4 Nm
Tightening torque of cover screw 1 lbf in	12.4 lbf in

### Components

Entry 1	4 x 8161/7-M25-1707 (Provided separately)
Entry 1 type	Polyamide cable gland, black
Entry 1	M25 x 1.5
Entry 1 terminal area	7-17 mm
Entry 1 clamping range, inch	0.28-0.67 in
Metal entry possible 1	No
Entry 2	2 x 8290/3-M25 (Provided separately)
Entry 2 type	Polyamide stopping plug
Entry 2	M25 x 1.5
Metal entry possible 2	No
Entries installation options/side	Size 3: 4x M25 (A+B+C+D)
Terminal rail	35 x 50 mm (1x)
Terminal rail	1,38 x 4,72 " (1x)
Type of terminals 1	11 x Phoenix UT 4 2-conductor, 4 mm <sup>2</sup> , grey
Type of terminals PE 1	2 x Phoenix USLKG 5 2-conductor, 4 mm <sup>2</sup> , green-yellow
	For connection cross-sections, see the manufacturer's data sheet

### Technical Drawings – Subject to Alterations

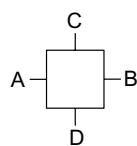

"—" = marking for mounting options

### Dimensional Drawings (All Dimensions in mm [inches]) – Subject to Alterations

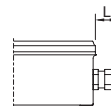
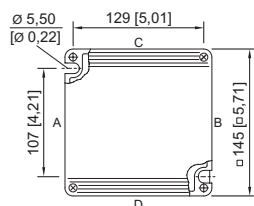
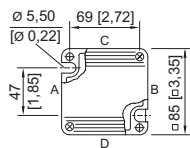
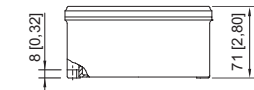
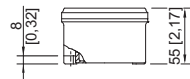

Length L  
 Projection dimension for cable gland of Series 8161:  
 For M20: 25 to 31 [0.98 to 1.22]  
 For M25: 27 to 33 [1.06 to 1.3]  
 For M32: 32 to 39 [1.26 to 1.54]  
 Projection dimension for cable gland with strain relief  
 of Series HSK-K-MZ  
 For M25: 41 [1.61]

8118/.1.  
Enclosure SZ 1

8118/.3.  
Enclosure SZ 3

### Accessories

8118/132-542-0 Art. No. 224646

### Cable gland made of plastic

Art. No.



8161/7-M25-1707, Ex e  
Plastic, M25 x 1.5, cable outer diameter 7 to 17 mm  
Lot size 50 pieces

239157

### Protective conductor terminal

Art. No.

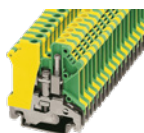

USLKG 5 (clamping range 4 mm<sup>2</sup>)  
The terminal enables protective conductors to be connected to the DIN rail. Colour green-yellow.

112760

### Stopping plug

Art. No.



8290/3-M25  
Plastic, M25 x 1.5  
Lot size 100 piece

285774

### Terminal block

Art. No.



Phoenix Contact terminal block UT 4

113045

### Brass plate with thread

Art. No.



8118 SZ 1, plate 37 x 30 mm [1.46 x 1.18 inch]  
1 x M20 x 1.5 with M4 PE connection (left)  
Can be installed in enclosures of SZ 1, SZ 2 and SZ 3

168913



8118 SZ 1, plate 37 x 30 mm [1.46 x 1.18 inch]  
1 x M20 x 1.5 with M4 PE connection (right)  
Can be installed in enclosures of SZ 1, SZ 2 and SZ 3

168914



8118 SZ 2, plate 56 x 40 mm [2.2 x 1.57 inch]  
2 x M20 x 1.5 with M4 PE connection (right)  
For installation in enclosure SZ 2 and SZ 3

244072



8118 SZ 2, plate 56 x 40 mm [2.2 x 1.57 inch]  
1 x M25 x 1.5 with M4 PE connection (left)  
For installation in enclosure SZ 2 and SZ 3

211341

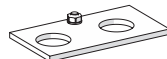

8118 SZ 3, plate 74 x 40 mm [2.91 x 1.57 inch]  
2 x M20 x 1.5 with M4 PE connection (centre)  
For installation in enclosure SZ 2 and SZ 3

168915

8118 SZ 3/B, plate 74 x 40 mm [2.91 x 1.57 inch]  
2 x M20 x 1.5 with M4 PE connection (centre)  
For installation in enclosure SZ 2 and SZ 3

244075

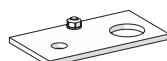

8118 SZ 3, plate 74 x 40 mm [2.91 x 1.57 inch]  
1 x M20 x 1.5 + 1 x M10 with M4 PE connection (centre)  
For installation in enclosure SZ 2 and SZ 3

211342

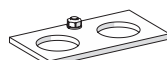

8118 SZ 3, plate 74 x 40 mm [2.91 x 1.57 inch]  
2 x M25 x 1.5 with M4 PE connection (centre)  
For installation in enclosure SZ 2 and SZ 3



168916



8118 SZ 3, plate 74 x 40 mm [2.91 x 1.57 inch]  
1 x M25 x 1.5 + 1 x M10 with M4 PE connection (centre)  
For installation in enclosure SZ 2 and SZ 3

211343

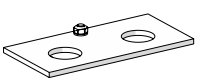
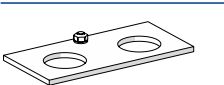
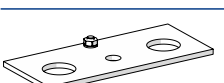
8118/132-542-0 Art. No. 224646

	<p>8118 SZ 4, plate 95 x 46 mm [3.74 x 1.81 inch] 2 x M20 x 1.5 with M4 PE connection (centre) For installation in enclosure SZ 3</p>	<p>168917</p>
	<p>8118 SZ 4, plate 95 x 46 mm [3.74 x 1.81 inch] 2 x M25 x 1.5 with M4 PE connection (centre) For installation in enclosure SZ 3</p>	<p>168918</p>
	<p>8118 SZ 5, plate 107 x 46 mm [4.21 x 1.81 inch] 2 x M20 x 1.5 + 1 x M10 with M4 PE connection For installation in enclosure SZ 3</p>	<p>211344</p>
	<p>8118 SZ 5, plate 107 x 46 mm [4.21 x 1.81 inch] 2 x M25 x 1.5 + 1 x M10 with M4 PE connection (centre) For installation in enclosure SZ 3</p>	<p>211345</p>

We reserve the right to make alterations to the technical data, dimensions, weights, designs and products available without notice. The illustrations cannot be considered binding.